

### PARTS INCLUDED

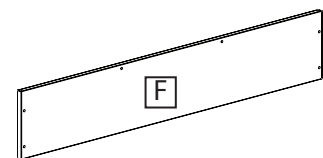

IF DESK IS 84" + EXTRA SUPPORT PIECES  
ARE REQUIRED

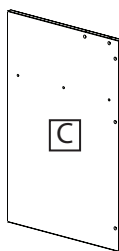
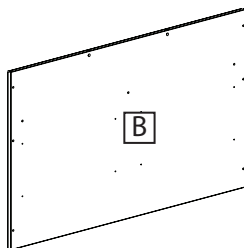
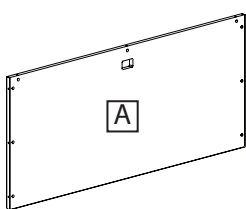
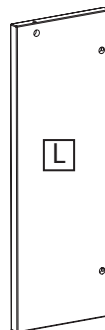
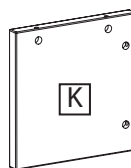

### HARDWARE INCLUDED



20X

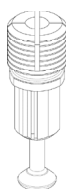

25X



22X

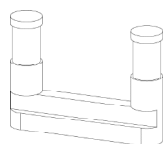

3X

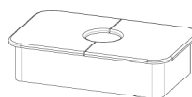

2X

Extra hardware may be included

### TOOLS REQUIRED

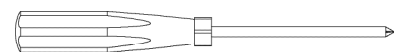

#2 Phillips Screwdriver

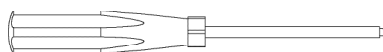

#2 Robertson screwdriver

### DISCLAIMER

- Two people are recommended for the assembly of this product.
- Use hardware provided and tools recommended to avoid any product faults.
- Always assemble product on a clean soft surface to avoid scratching.

## STEP 1

Ensure all pins and cams are inserted in parts before assembling. Attach desk top **A** and left gable **C** as shown. Fasten pins and cams.

If desk is 84" + move to STEP 3.

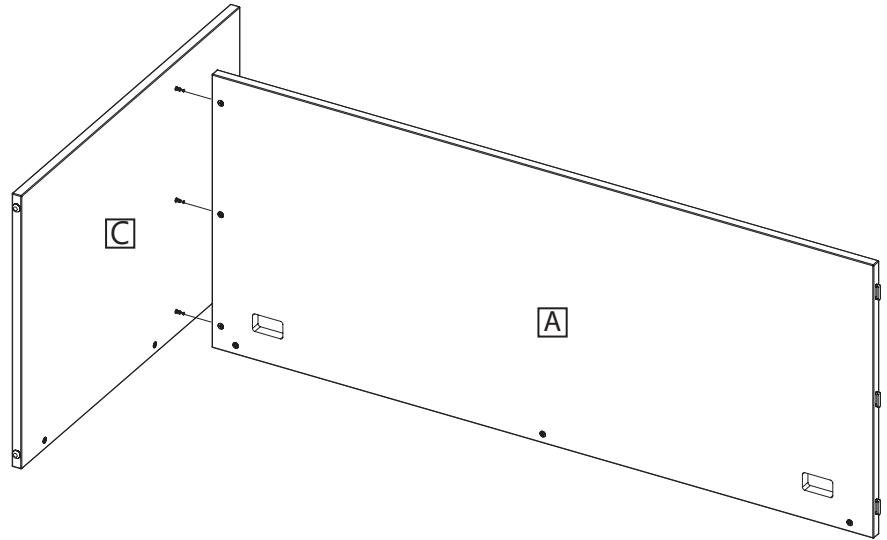

## STEP 2

Lay desk back **B** flat and lower top and gable onto back as shown. Fasten pins and cams. Flip desk right side up.

Move to STEP 6.

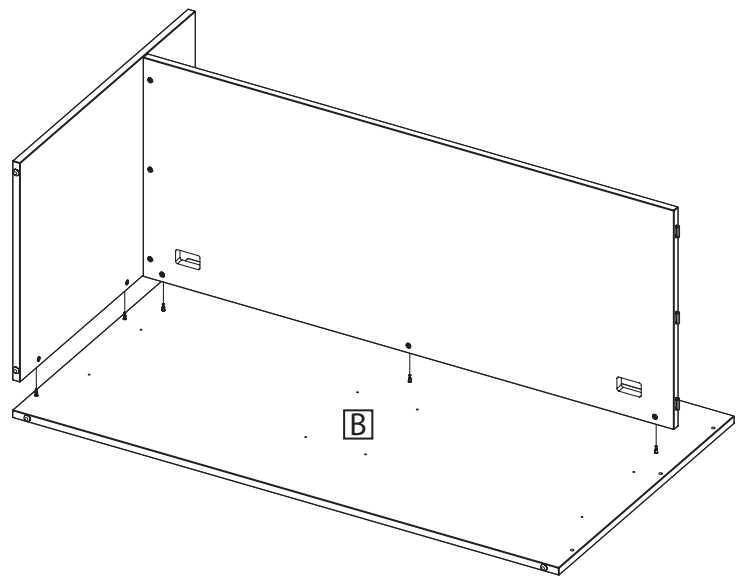

## STEP 3

If desk is 84" + attach desk support gable **L**  
Fasten pins and cams.

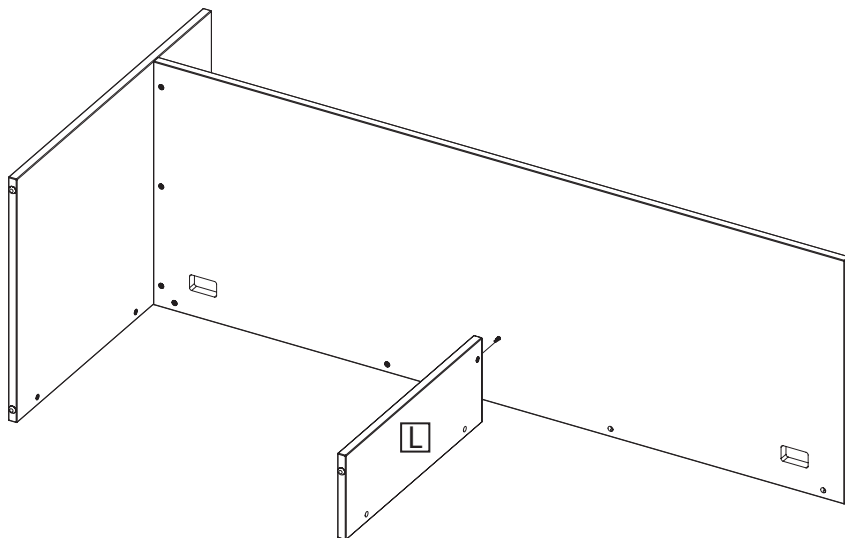

## STEP 4

Lay desk back **B** flat and lower top and gables onto back as shown. Fasten pins and cams. Flip desk right side up.

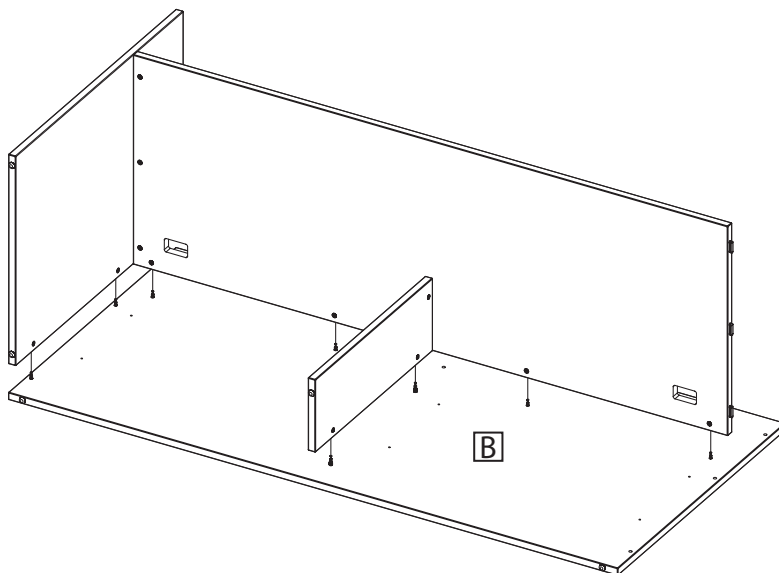

## STEP 5

If desk is 84" + , attach transaction ledge support **K** to desk back. Fasten pins and cams.

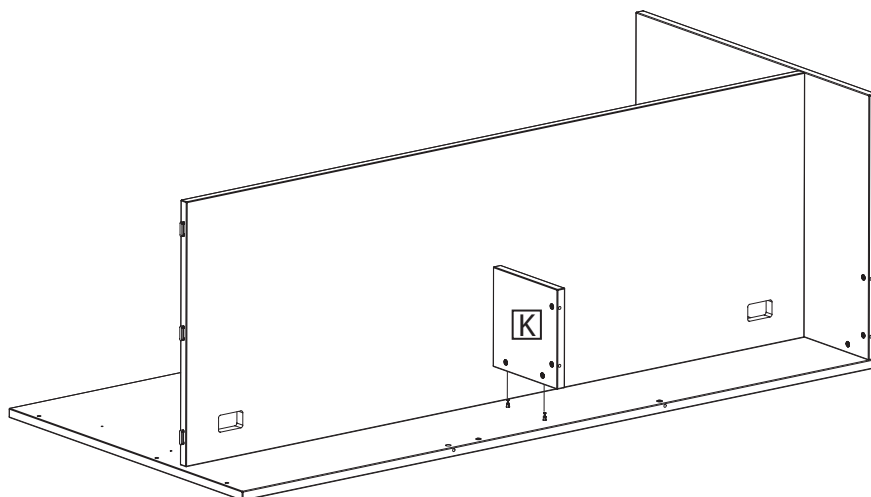

## STEP 6

To connect the desk and return insert green lockdowels into the edge of the desk top. Line lockdowels with the slots in the return back. Slide the return back into the desk back. Fasten pins and cams.

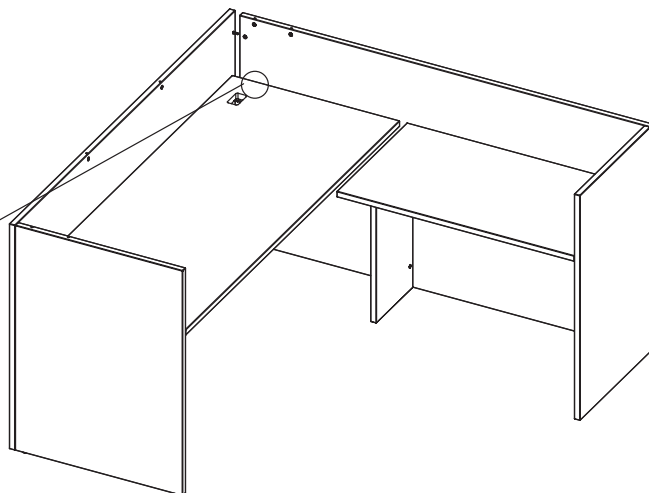
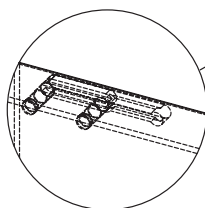
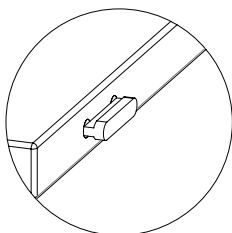

## STEP 7

Attach transaction top **F** to desk back. Fasten pins and cams.

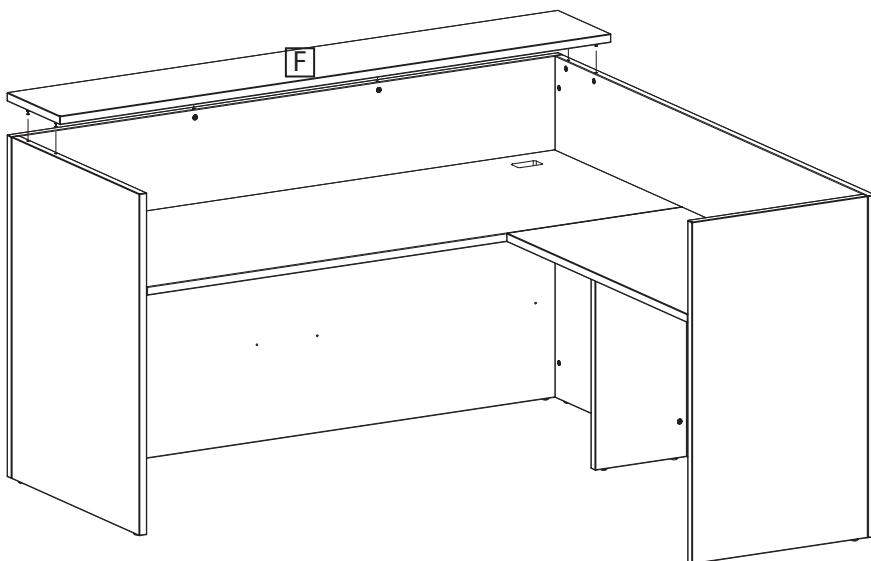

## STEP 8

See W-01R - Return instructions to finish off assembly of L shape.

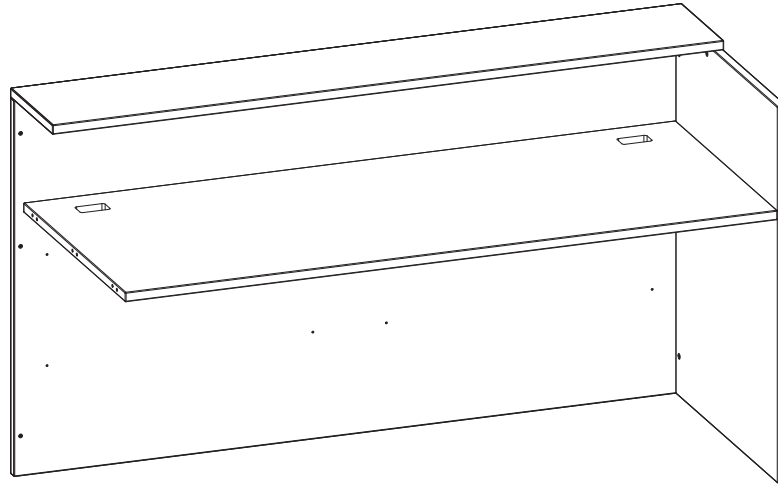

## PARTS INCLUDED

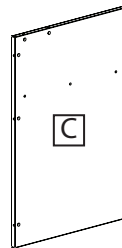
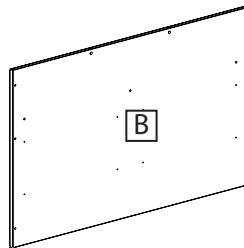
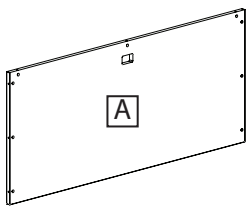

IF DESK IS 84" + EXTRA SUPPORT PIECES  
ARE REQUIRED

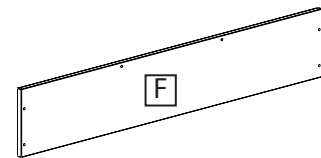
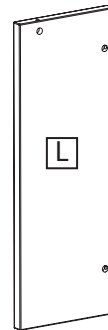
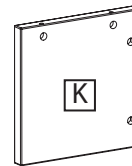

## HARDWARE INCLUDED



20X

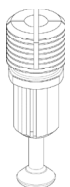

25X



22X

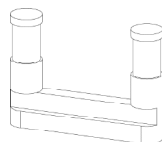

3X

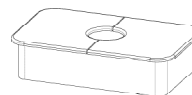

2X

Extra hardware may be included

## TOOLS REQUIRED

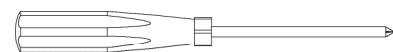

#2 Phillips Screwdriver

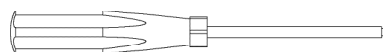

#2 Robertson screwdriver

## DISCLAIMER

- Two people are recommended for the assembly of this product.
- Use hardware provided and tools recommended to avoid any product faults.
- Always assemble product on a clean soft surface to avoid scratching.

## STEP 1

Ensure all pins and cams are inserted in parts before assembling. Attach desk top **A** and right gable **C** as shown. Fasten pins and cams.

If desk is 84" + move to STEP 3.

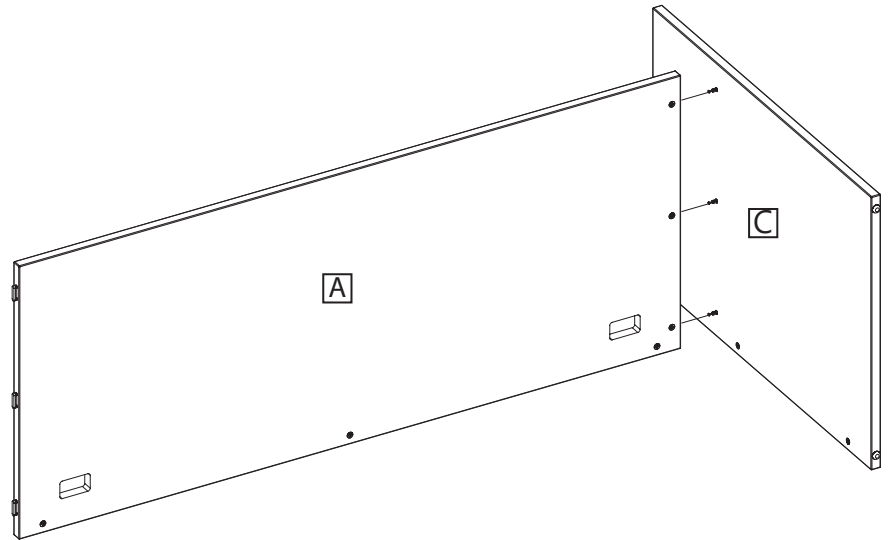

## STEP 2

Lay desk back **B** flat and lower top and gable onto back as shown. Fasten pins and cams. Flip desk right side up.

Move to STEP 6.

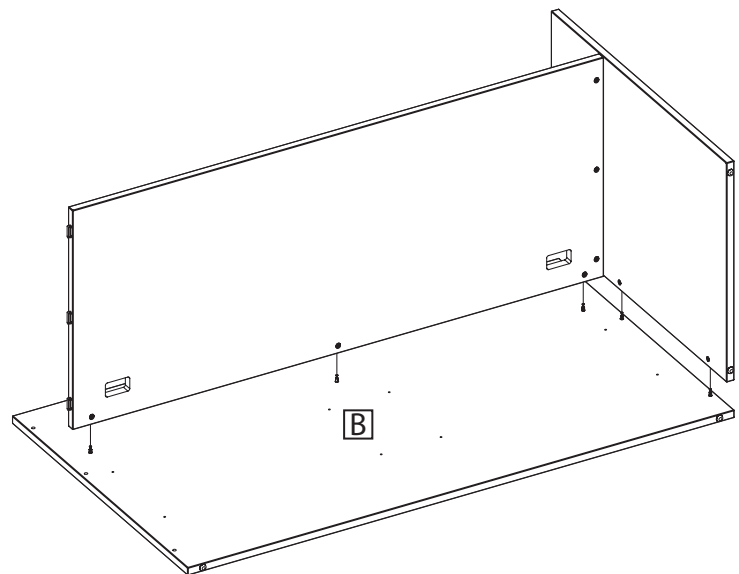

## STEP 3

If desk is 84" + attach desk support gable **L**  
Fasten pins and cams.

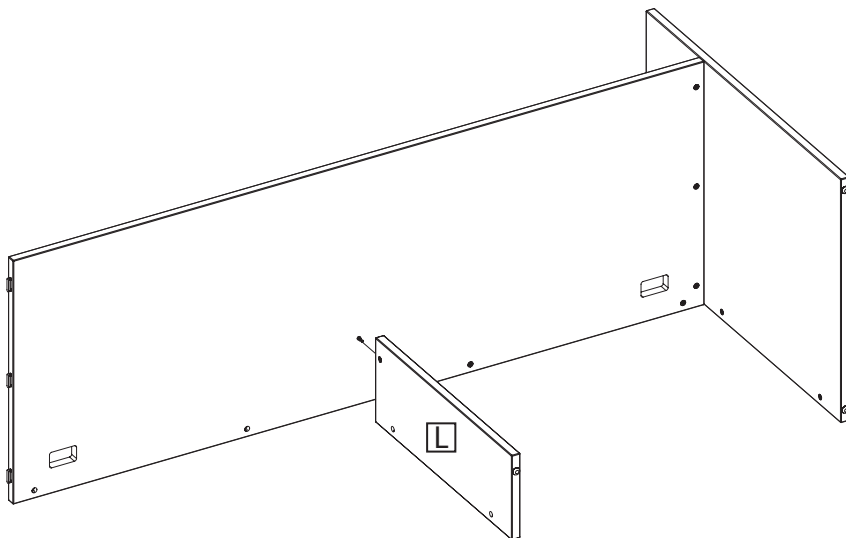

## STEP 4

Lay desk back **B** flat and lower top and gables onto back as shown. Fasten pins and cams. Flip desk right side up.

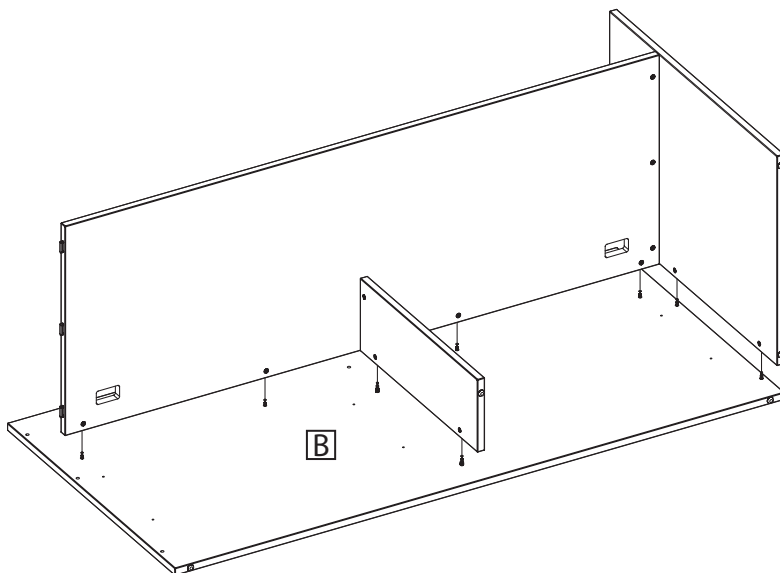

## STEP 5

If desk is 84" + , attach transaction ledge support **K** to desk back. Fasten pins and cams.

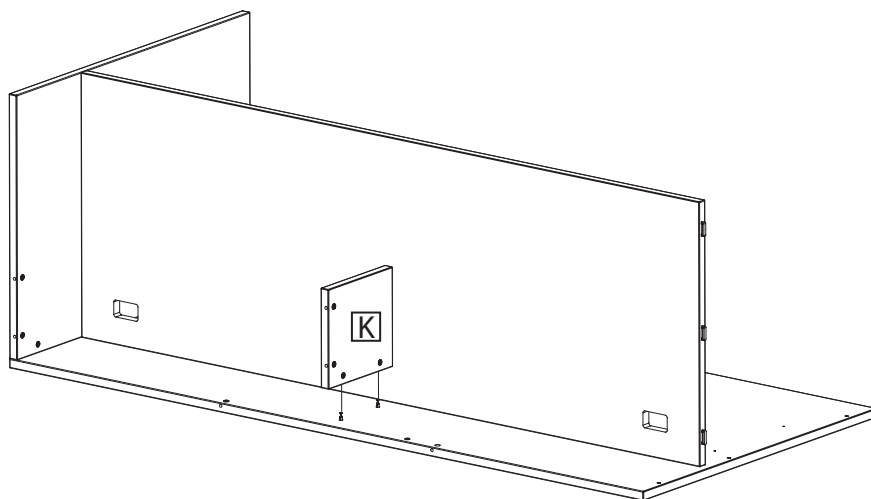

### STEP 6

To connect the desk and return insert green lockdowels into the edge of the desk top. Line lockdowels with the slots in the return back. Slide the return back into the desk back. Fasten pins and cams.

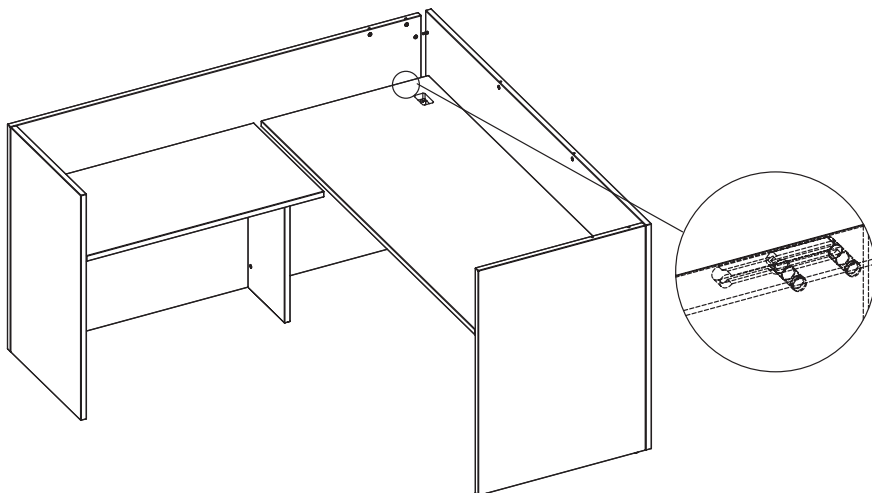
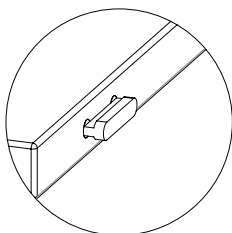

### STEP 7

Attach transaction top **F** to desk back. Fasten pins and cams.

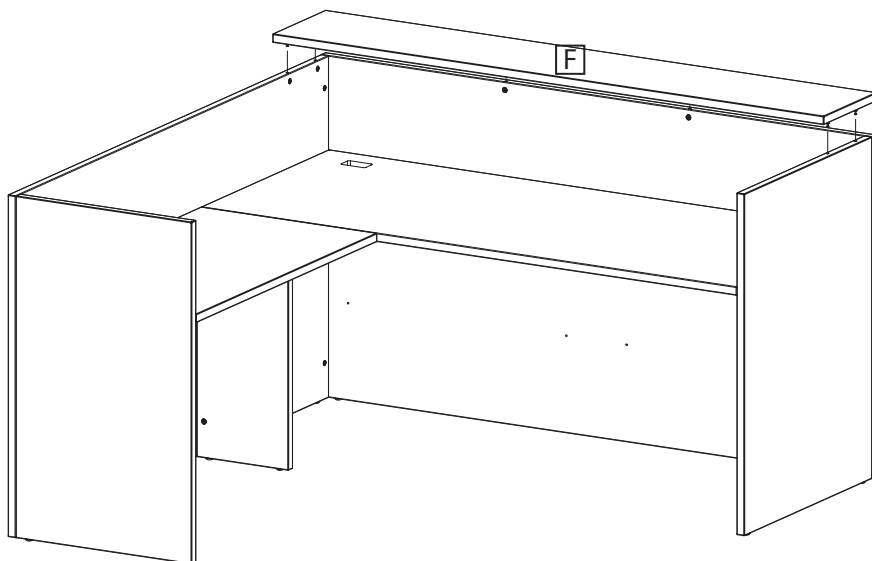

### STEP 8

See W-01L - Return instructions to finish off assembly of L shape.



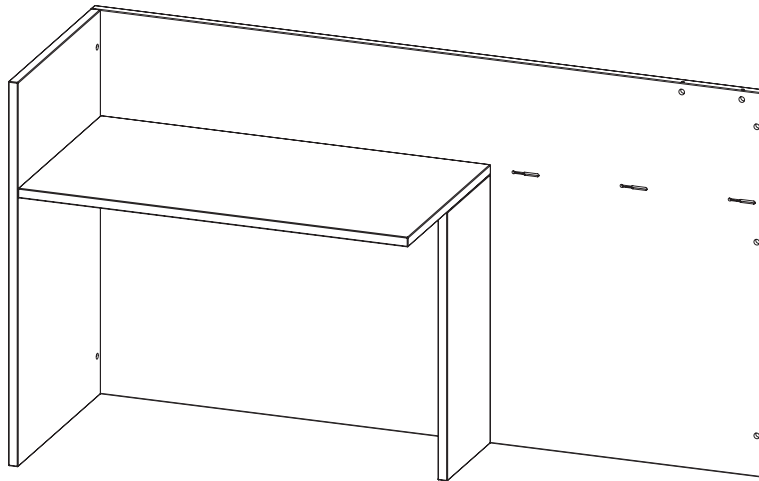

### PARTS INCLUDED

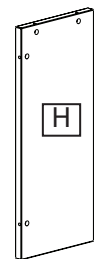
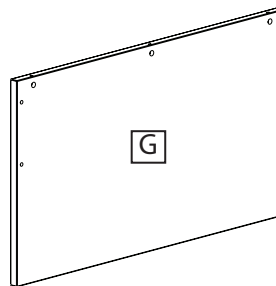
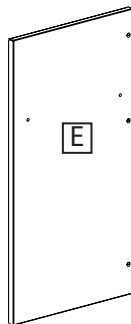
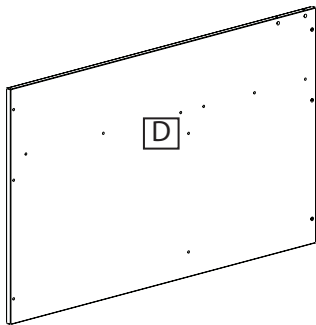

### HARDWARE INCLUDED



17X

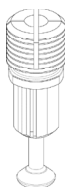

12X



12X

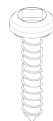

12X

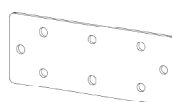

2X

Extra hardware may be included

### TOOLS REQUIRED

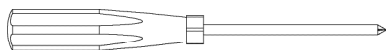

#2 Phillips Screwdriver

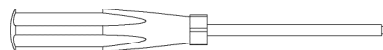

#2 Robertson screwdriver

### DISCLAIMER

- Two people are recommended for the assembly of this product.
- Use hardware provided and tools recommended to avoid any product faults.
- Always assemble product on a clean soft surface to avoid scratching.

## STEP 1

Attach return top **G** and left gable **E** as shown. Fasten pins and cams.

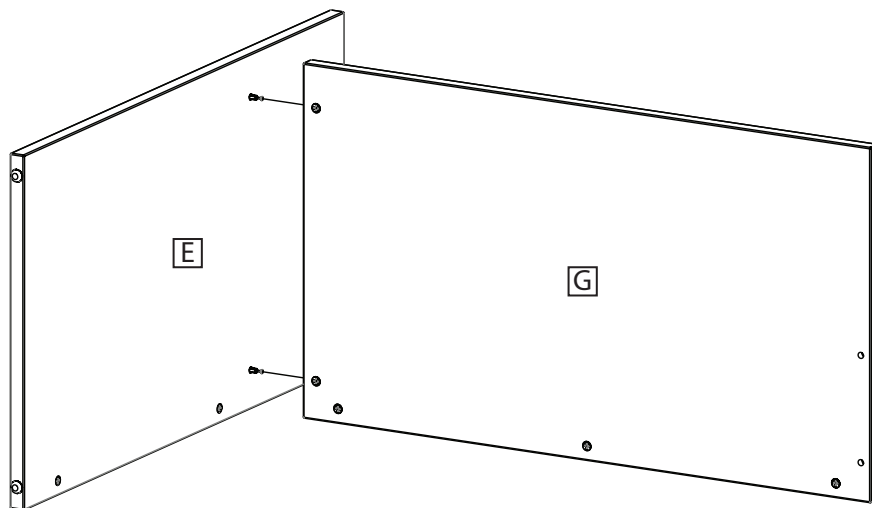

## STEP 2

Connect small support gable **H** to return top. Fasten pins and cams.

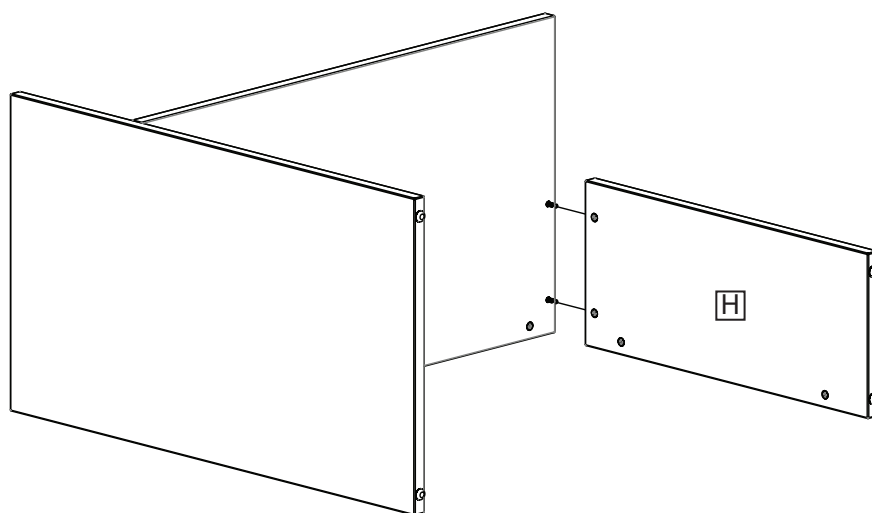

## STEP 3

Lay return back **D** flat and lower top and gables onto back. Fasten pins and cams and flip unit right side up.

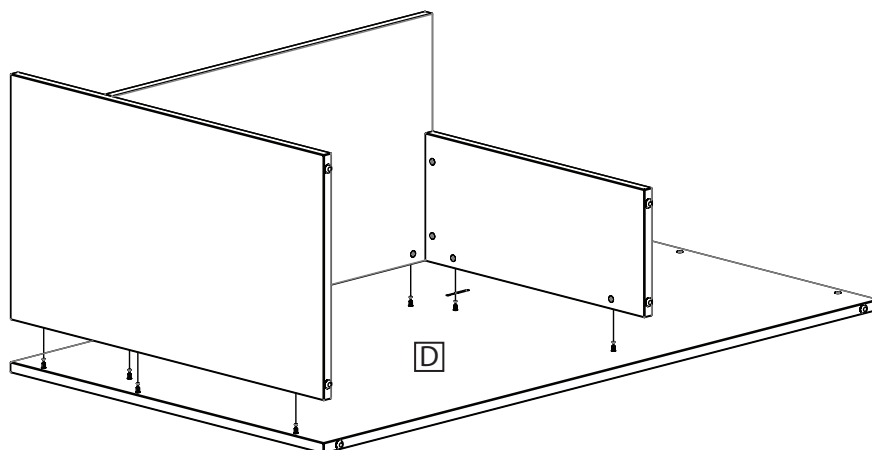

## STEP 4

To connect the desk and return insert green lockdowels into the edge of the desk top. Line lockdowels with the slots in the return back. Slide the return back into the desk back. Fasten pins and cams.

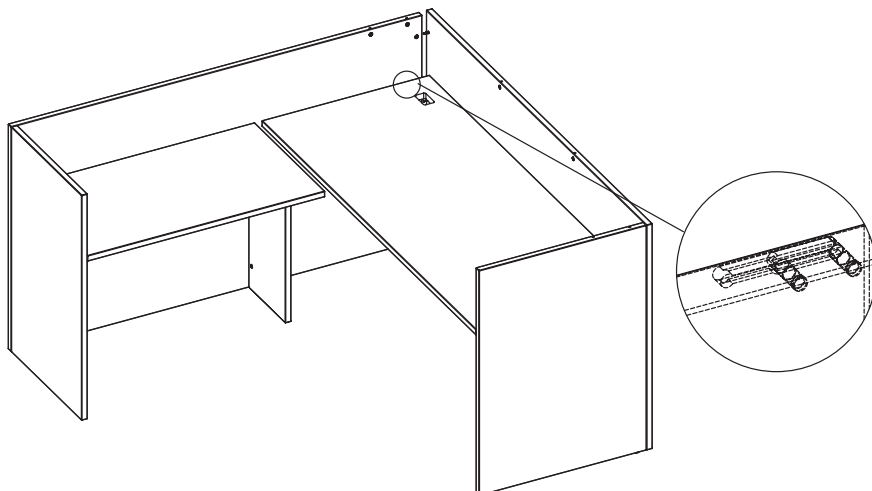
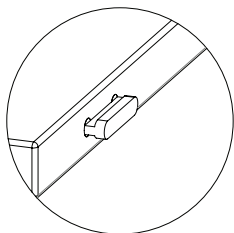

## STEP 5

Secure return top to desk top with connecting flat brackets as shown.

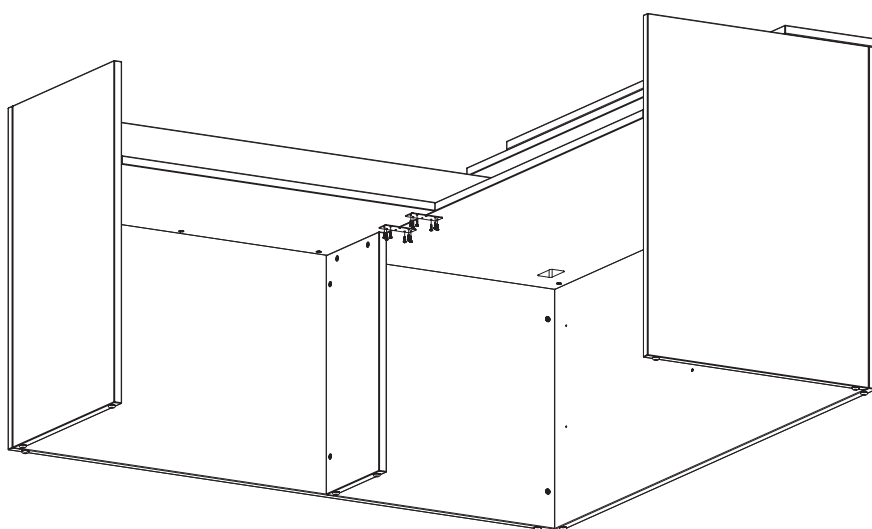
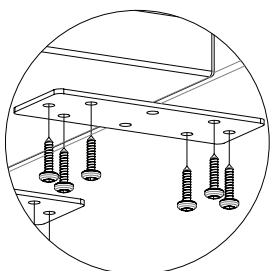

## STEP 6

See W-01x - Waterfall instructions to finish off assembly of L shape.

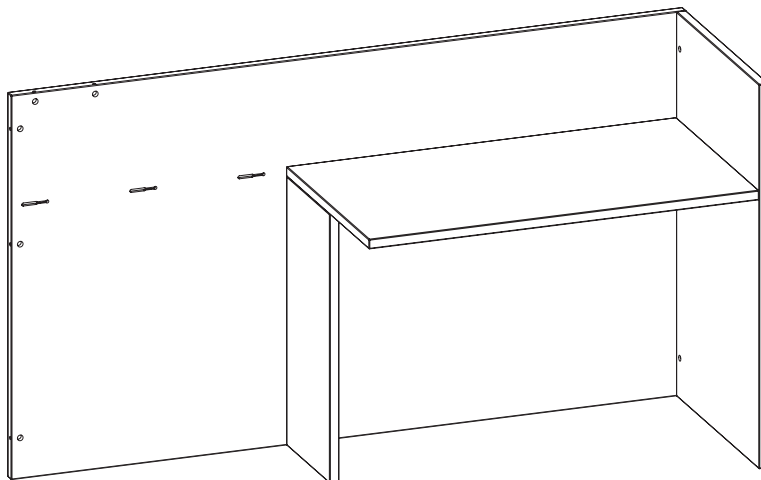

### PARTS INCLUDED

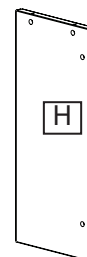
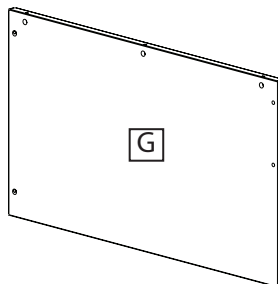
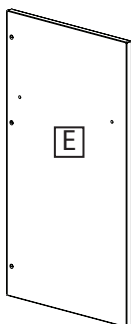
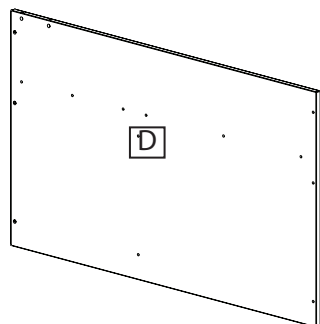

### HARDWARE INCLUDED



17X



12X



12X

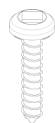

12X

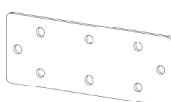

2X

Extra hardware may be included

### TOOLS REQUIRED

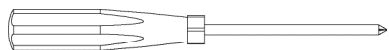

#2 Phillips Screwdriver

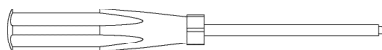

#2 Robertson screwdriver

### DISCLAIMER

- Two people are recommended for the assembly of this product.
- Use hardware provided and tools recommended to avoid any product faults.
- Always assemble product on a clean soft surface to avoid scratching.

## STEP 1

Attach return top **G** and right gable **E** as shown. Fasten pins and cams.

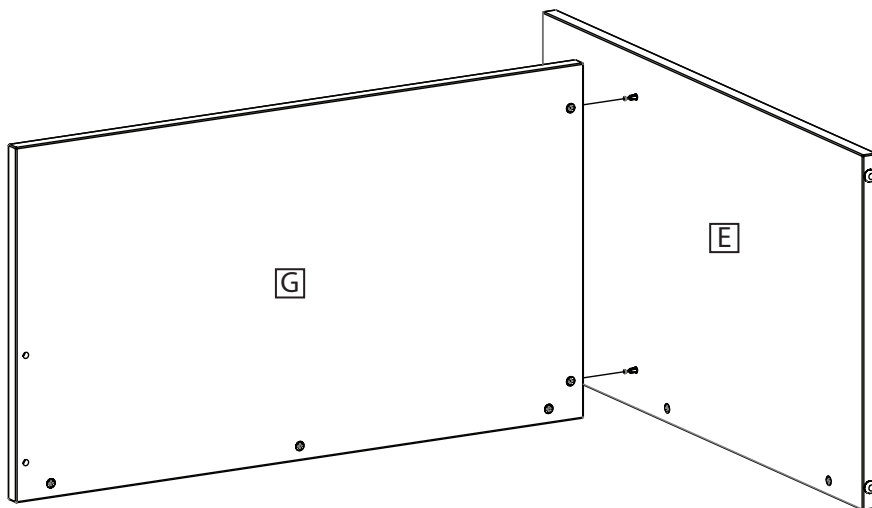

## STEP 2

Connect small support gable **H** to return top. Fasten pins and cams.

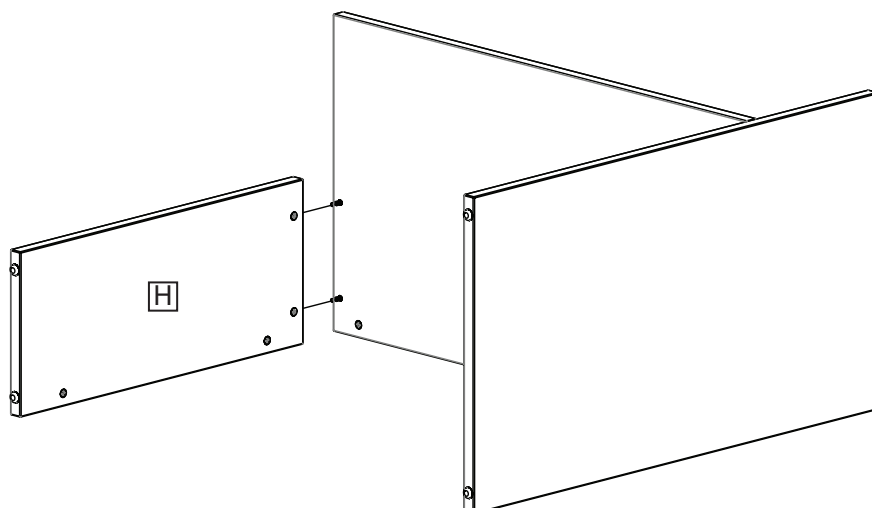

## STEP 3

Lay return back **D** flat and lower top and gables onto back. Fasten pins and cams and flip unit right side up.

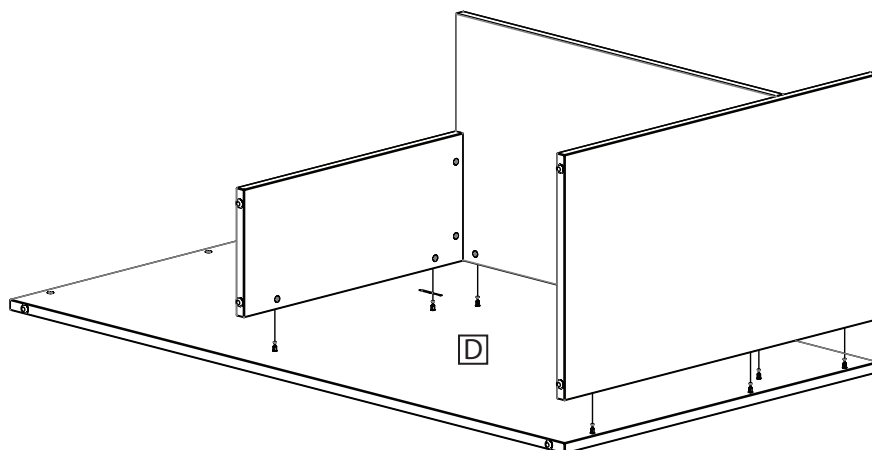

## STEP 4

To connect the desk and return insert green lockdowels into the edge of the desk top. Line lockdowels with the slots in the return back. Slide the return back into the desk back. Fasten pins and cams.

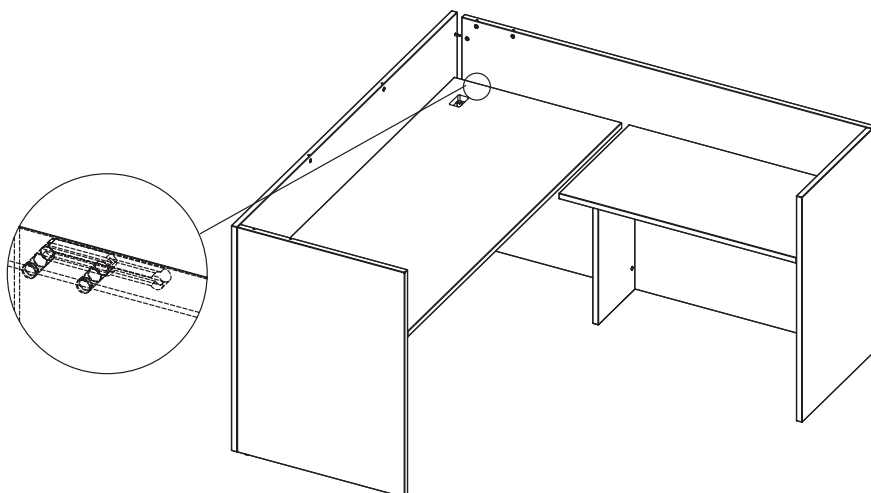
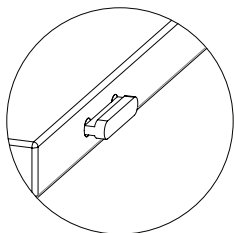

## STEP 5

Secure return top to desk top with connecting flat brackets as shown.

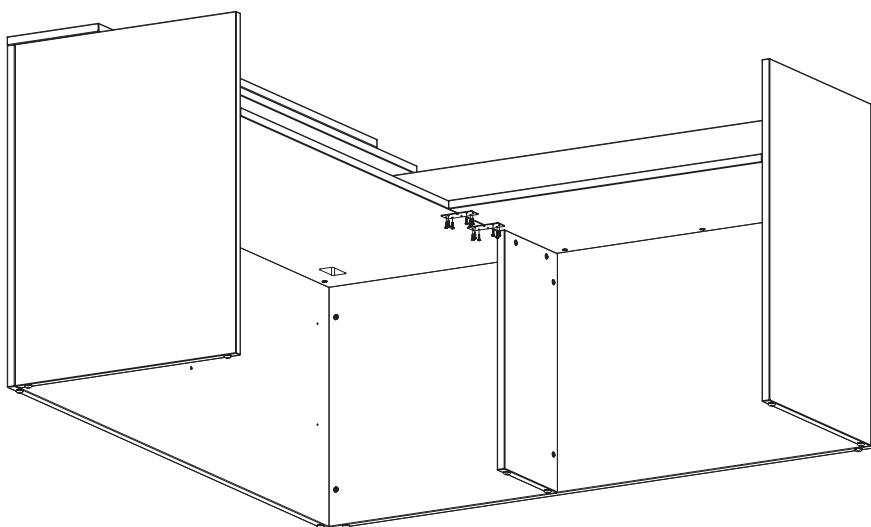
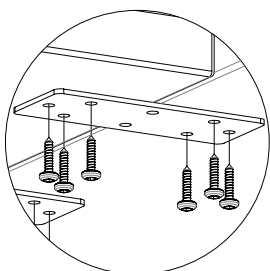

## STEP 6

See W-01x - Waterfall instructions to finish off assembly of L shape.

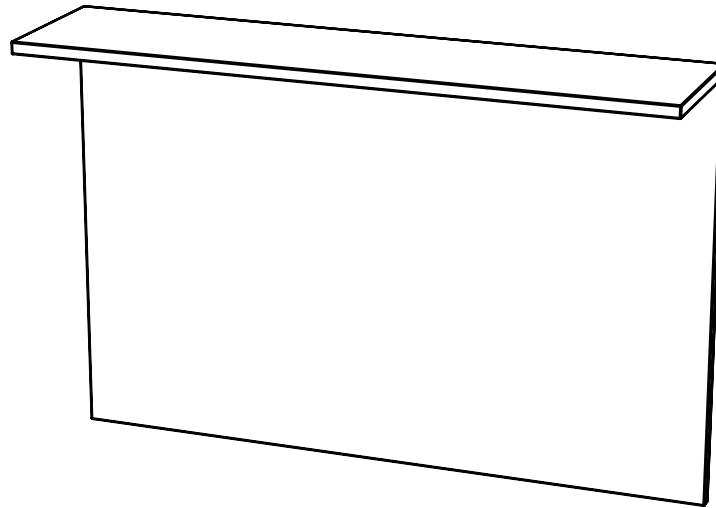

### PARTS INCLUDED

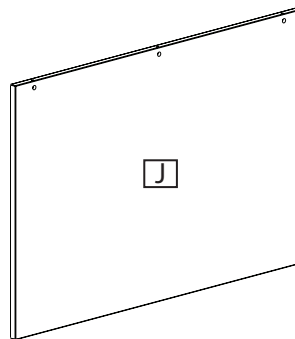
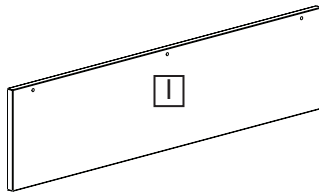

### HARDWARE INCLUDED



3X

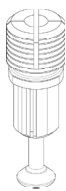

3X



4X

### TOOLS REQUIRED

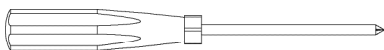

#2 Phillips Screwdriver

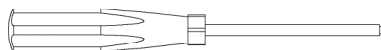

#2 Robertson screwdriver

### DISCLAIMER

- Two people are recommended for the assembly of this product.
- Use hardware provided and tools recommended to avoid any product faults.
- Always assemble product on a clean soft surface to avoid scratching.

## STEP 1

Connect waterfall top **I** and back **J** as shown. Fasten pins and cams.

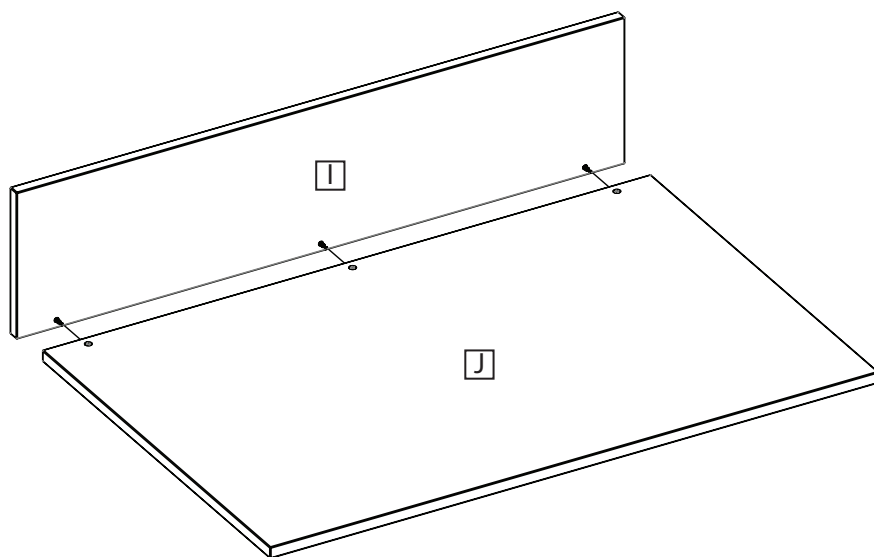

## STEP 2

Remove backing from double sided tape on top of waterfall. Place waterfall on center of transaction top and secure with screws through large back.

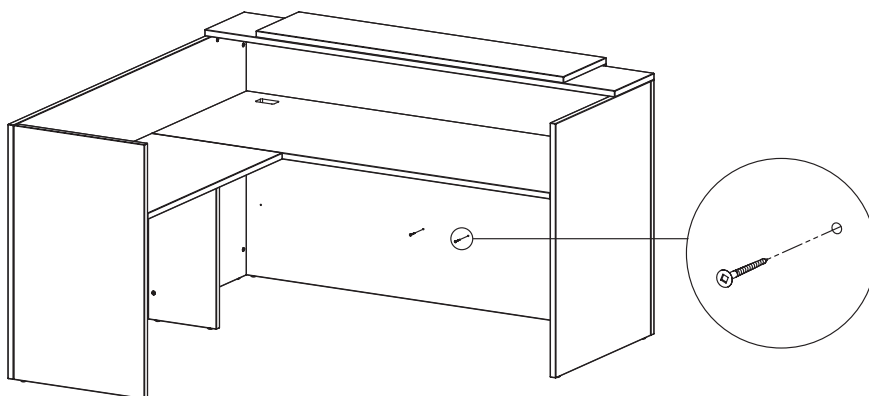

## STEP 3

Use cover caps to cover any visible cams and screws.

